

DEPARTMENT OF ENGINEERING  
 CITY OF SAN BERNARDINO  
 DEL ROSA AVENUE BETWEEN ECHO DRIVE AND A POINT SOUTH OF DEL ROSA AVENUE  
 ECHO DRIVE BETWEEN DEL ROSA AVENUE AND CO FLOOD  
 FOOTHILL DRIVE BETWEEN DEL ROSA AVENUE AND OSBUN ROAD  
 OSBUN ROAD BETWEEN FOOTHILL DRIVE AND A POINT SOUTH OF FOOTHILL DRIVE  
 BELMONT COURT BETWEEN OSBUN ROAD AND A POINT SOUTH OF OSBUN ROAD  
 MESA VERDE DRIVE EAST AND WEST OF OSBUN ROAD  
 EXISTING MANHOLE LOCATIONS AND PROPOSED MANHOLES  
 APPROVED OCTOBER 30 1922 DRAWN BY  
 REGISTERED CIVIL ENGINEER NO. 2072 CHECKED BY

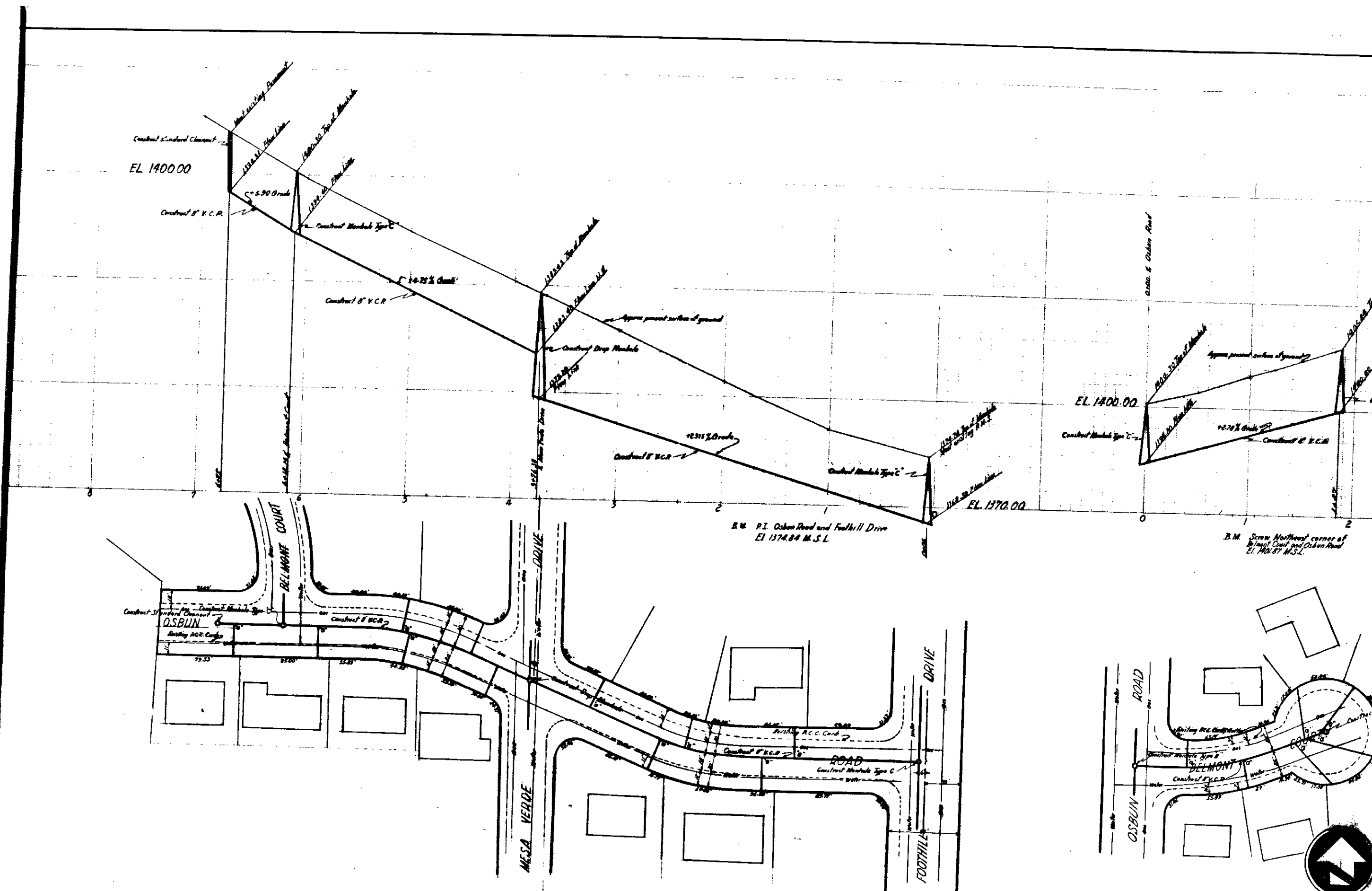

Scale 1"=40'



Scale 1"=40'

DEPARTMENT OF ENGINEERING  
 CITY OF SAN BERNARDINO  
 DEL ROSA AVENUE BETWEEN ECHO DRIVE AND A POINT SOUTH OF DEL ROSA AVENUE  
 ECHO DRIVE BETWEEN DEL ROSA AVENUE AND CO FLOOD  
 FOOTHILL DRIVE BETWEEN DEL ROSA AVENUE AND OSBUN ROAD  
 OSBUN ROAD BETWEEN FOOTHILL DRIVE AND A POINT SOUTH OF FOOTHILL DRIVE  
 BELMONT COURT BETWEEN OSBUN ROAD AND A POINT SOUTH OF OSBUN ROAD  
 MESA VERDE DRIVE EAST AND WEST OF OSBUN ROAD  
 EXISTING MANHOLE LOCATIONS AND ELEVATIONS  
 SUBMITTED FOR REVIEW AND APPROVAL  
 APPROVED OCTOBER 30 1952 DRAWN BY  
 CITY ENGINEER REGISTERED CIVIL ENGINEER NO. 2072  
 CHECKED BY